

MOTOROLA CONFIDENTIAL PROPRIETARY

		TITLE: P383 GSM REFERENCE DESIGN NON ADJUNCT CASE BASEBAND PROCESSOR
REV: 1.1 Drawing Number:	Page: 4 Of:	Date: Thursday, June 25, 2003 Time: 3:48:03 pm
Change Log:		
P2 Changes 12-19-2002 01-07-2003 01-08-2003 01-10-2003 01-14-2003 01-15-2003 01-22-2003 02-21-2003 02-26-2003 03-06-2003 03-13-2003 03-14-2003 03-20-2003 03-28-2003 04-02-2003 04-23-2003 04-29-2003 04-30-2003 06-16-2003	Added U76, R732, R733ONP R733ONP, R736ONP zero ohms Changed C881 from FT518TN805 to 4800-02N61 C830 Value change from 1pF to 5.1pF R827 from 0 ohms to 10k ohms Added R833ONP 0 ohm RES Removed ONP from R833 Renamed JTAG test pads to match pin Added TP_GND & TP_VD_REG for JTAG DNP R732; Placed R733 & R735 Added TP_RESETB Added S4800 Changed C830 from 5.2pF to 6.8pF DNP C205 P3.1 Deleted Bluetooth Buffer U802 Changed net names BLUE_HOST, WAKE1 to BLUE_HOST, WAKE BLUE_WAKE1 to BLUE_WAKE1 Deleted C810NP, C820NP, R720NP, R731, R734ONP, R735, R735ONP, R733, R736ONP, R736, C795, C796, C797, TP_VPP, C794, R812, R813ONP, R834ONP, R833, R835, R835ONP, R840NP Deleted POWER_CUST5, VCC4 & POWER_CUT5, CS18 pins Implemented new GPIO Changes Deleted R830NP & R837 Added C883 pin R818R2A15 Added back in C810NP & C820NP Added back in R706, R855ONP, R810 R812, R813ONP, R8303 Added TP to PC12 (TP_PC12) Deleted C883 Added V8300 & V8001 Remove R706 from P800 to U701 ADDRESS2H input to U701 Added TP_ADC_N & TP_ADC_P Deleted TP_ADC_N & TP_ADC_P Updated 0.01uF Decoupling CAPs to 0.1uF P3.2 Added 2 zero ohms to enable light sensor R837 & R838 to IO_REG R811 Value change from 0 to 1k Ohms DNP the following: R810, C803, C804, R805 Change LVTD from REF_REG to POWER_CUT5, VCC Changed U701 to PIN 51002Z500 Changed U800 to PIN 51912N001 Added C85 and VPP_SIGNAL for SV Flashing	

D

Remove the MOD Test point and resistor R805 on the final production board.
Need to add Jumper to Wing board.

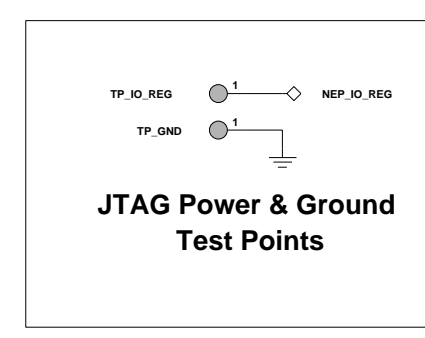
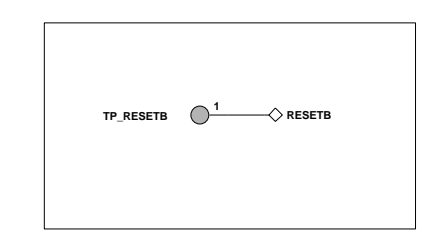

C

B

A

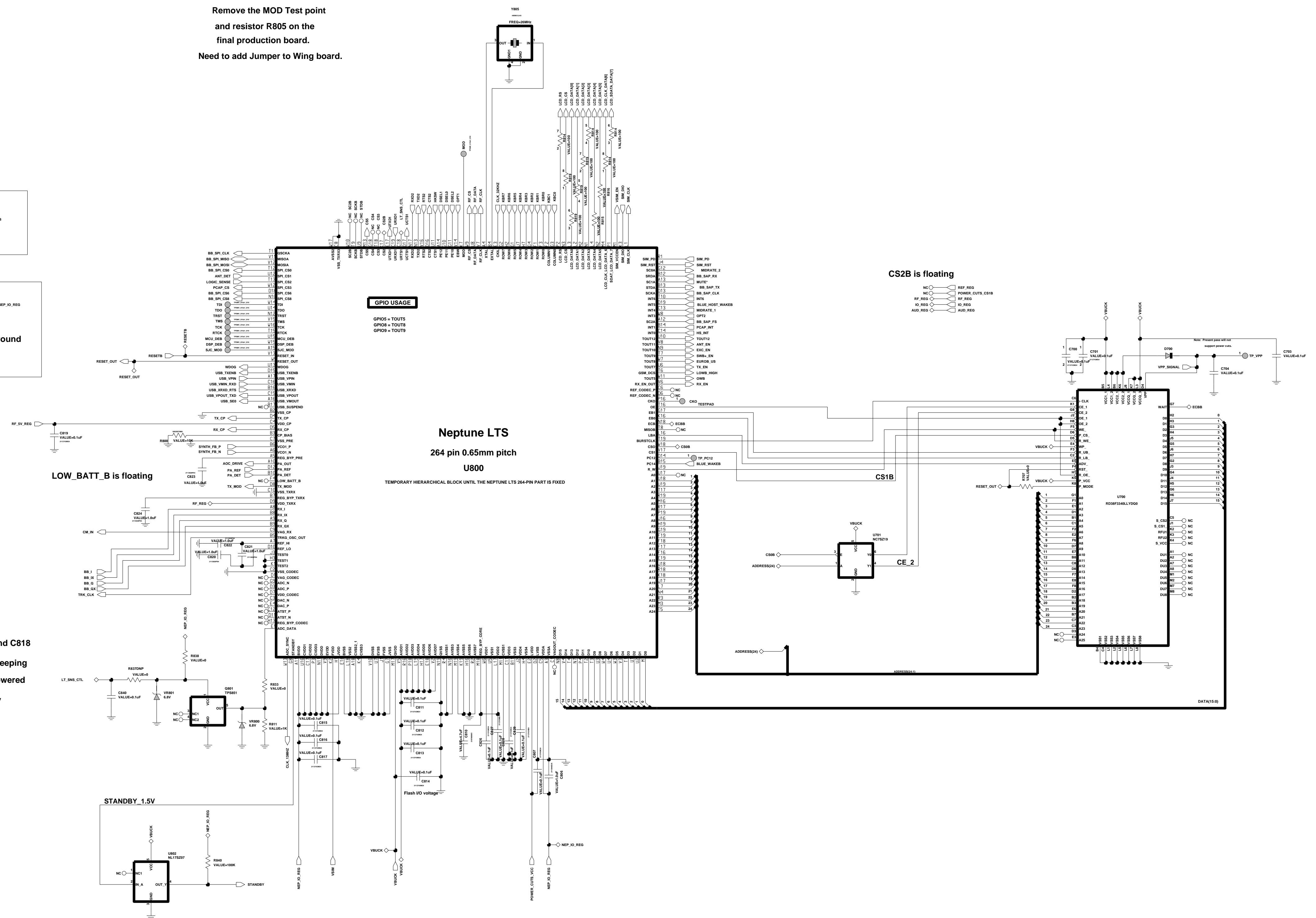

Only place R810, R811 and C818 if there is an issue in keeping the CODEC and ADC unpowered
Route JVDD carefully

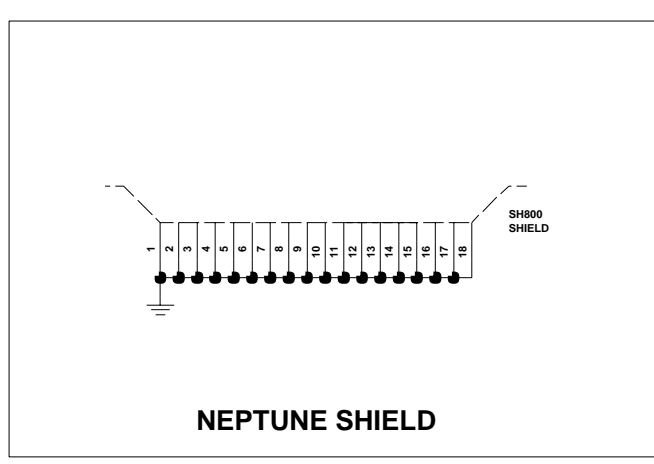

MOTOROLA CONFIDENTIAL PROPRIETARY

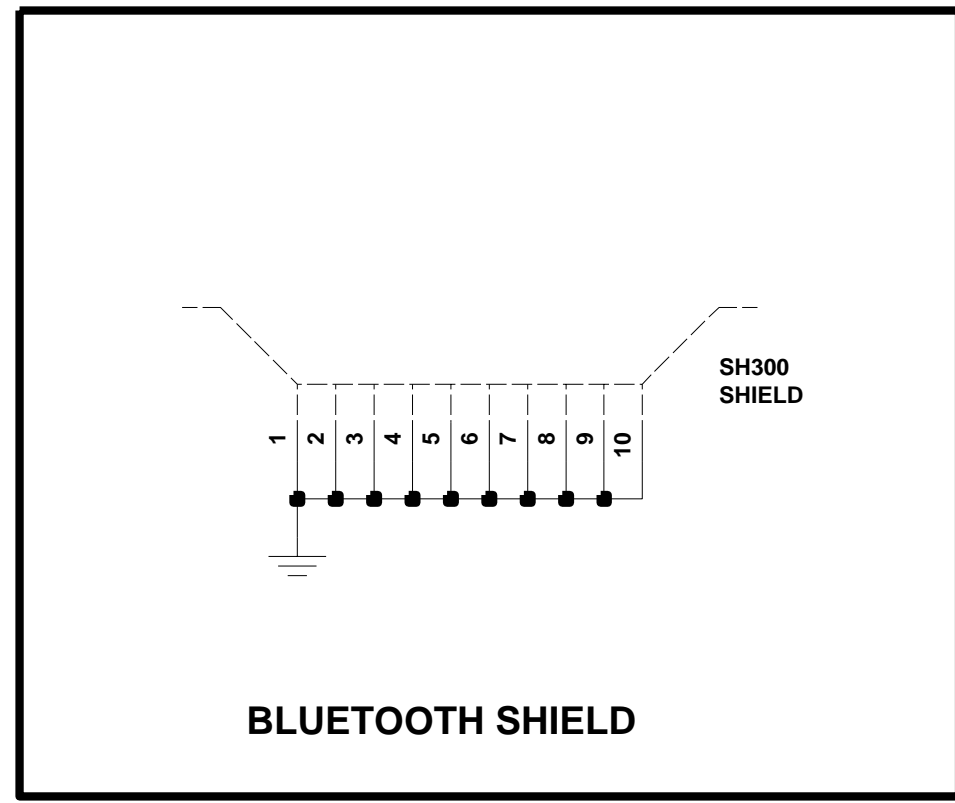
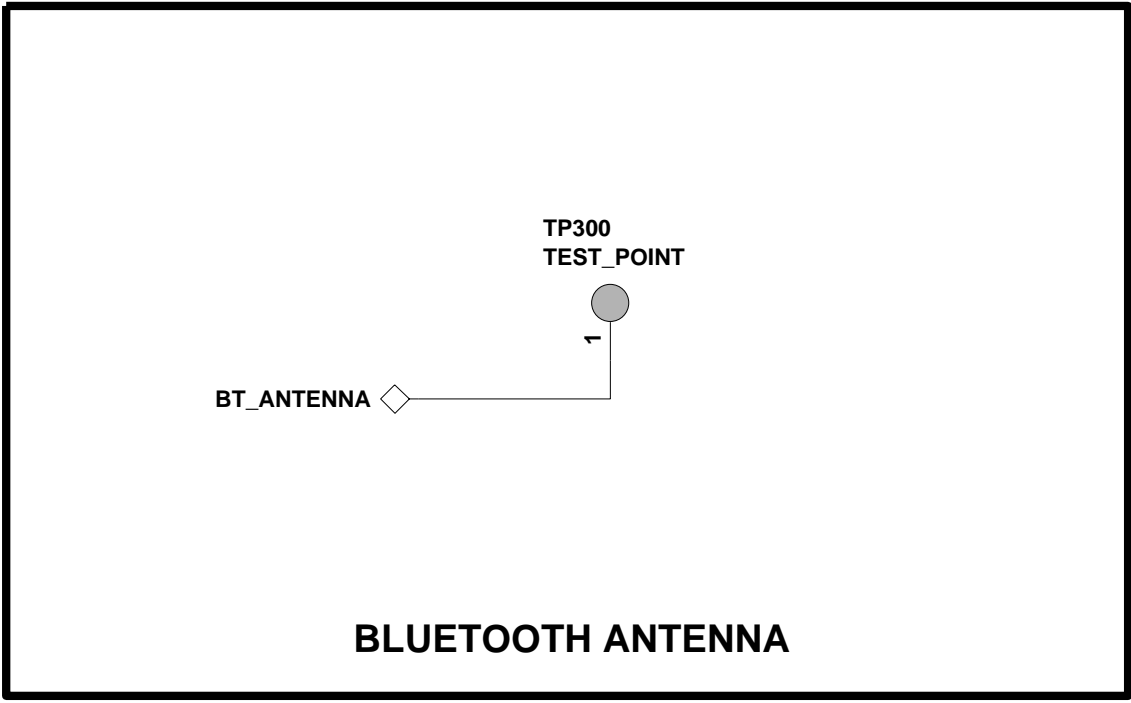
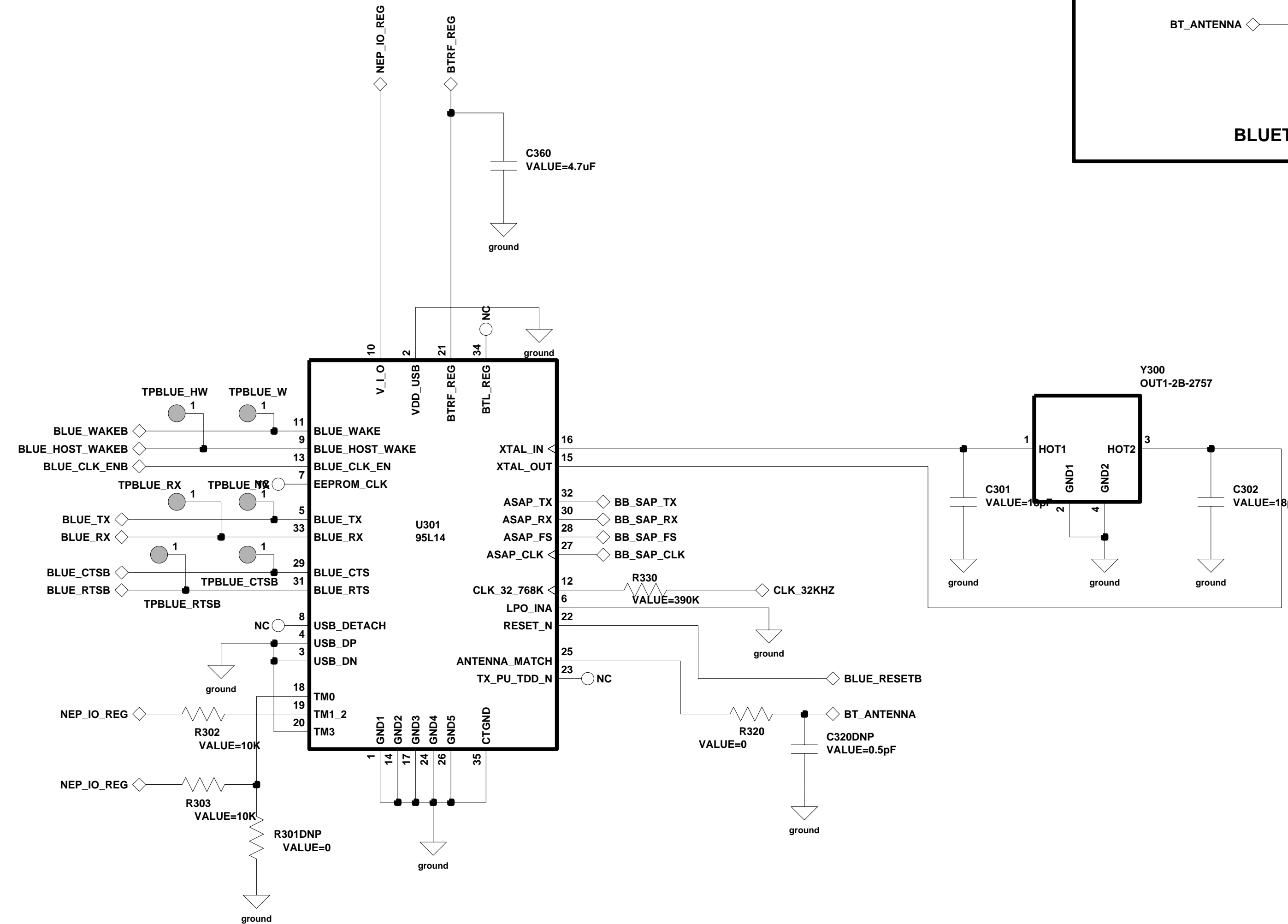
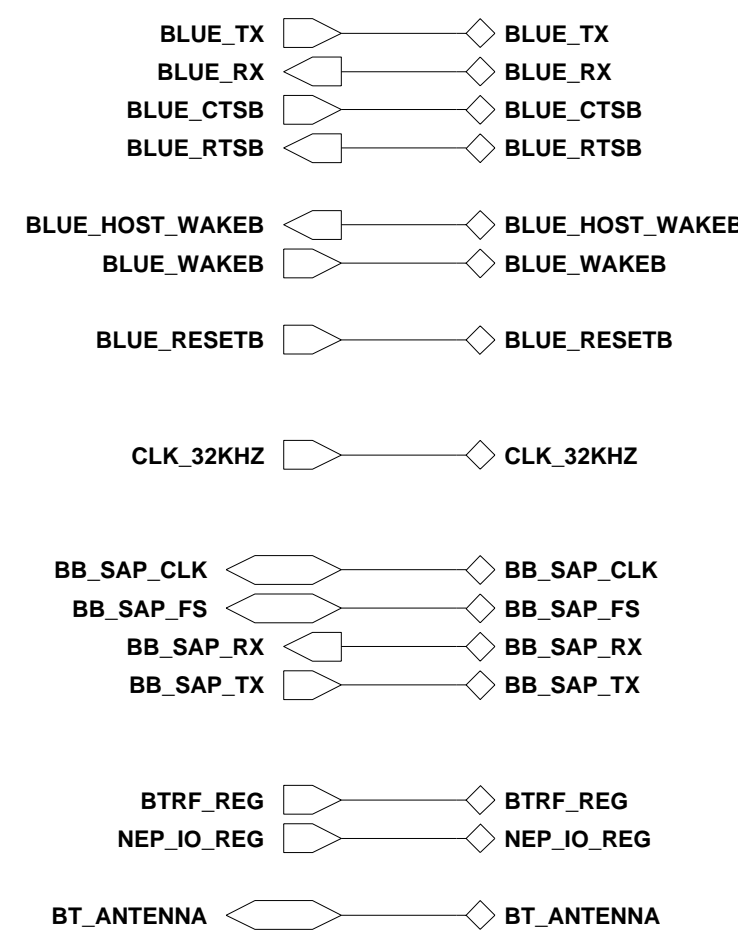

Supply Name	VDC
BTRF_REG	1.8
NEP_IO_REG	2.75

Engineer:	MOTOROLA INC.		
Drawn by:			
R&D CHK:	TITLE: BCC_P2_Bluetooth	Size:	
DOC CTRL CHK:			
MFG CTRL CHK:			
QA CHK:	REV:	Drawing Number:	Page: Of:
Changed by:	Date: 02-26-2003	Time:	
R. S. Nelson 11-22-2002	Initial module schematic		
P2 Changes 12-13-2002	Disconnect ground node from BT_ANTENNA signal & TP300		
01-08-2003	C306 Value change from 10pF to .01uF Added R351, R352, R354DNP, C350, & L350 Added TP32KHZ, TPBLUE_W, & TPBLUE_HW REF DES change R350 to R300 REF DES change R351 to R301 Removed E300 & E301 Connected TRK_CLK Port		
01-29-2003	Deleted TPCLK_32KHZ P2A		
02-21-2003	Change C350 from 0.01uF to 33pF Change C306 from 0.01uF to 33nF		
02-26-2003	DNP L350 P3.1 Change Net names BLUE_RTS* to BLUE_RTSB BLUE_CTS* to BLUE_CTSB BLUE_HOST_WAKE* to BLUE_HOST_WAKEB BLUE_WAKE* to BLUE_WAKEB BLUE_RESET* to BLUE_RESETB Deleted Ports BLUE_CLK_EN* VBUCK TRK_CLK		
	Added BT 26MHZ Crystal and 2 CAPs Added TPBLUE_RTSB & TPBLUE_CTSB Removed R362, R361, C306, R352 R351, R350, C350, R354DNP, R310 R303DNP, R300, E302-E305 Changed R301 from 8.2K to 10K Added R303DNP 10K Pull Up to IO_REG		
03-05-2003	Rmored C361 from BTL_REG		
03-28-2003	Added R330 200k Ohms Change RESET_OUT to RESETB on Top level		
04-02-2003	Deleted TP301 & TP302		
04-28-2003	Updated R330 from 200K to 390K P3.2 Changed C301 & C302 from 43pF to 18pF		

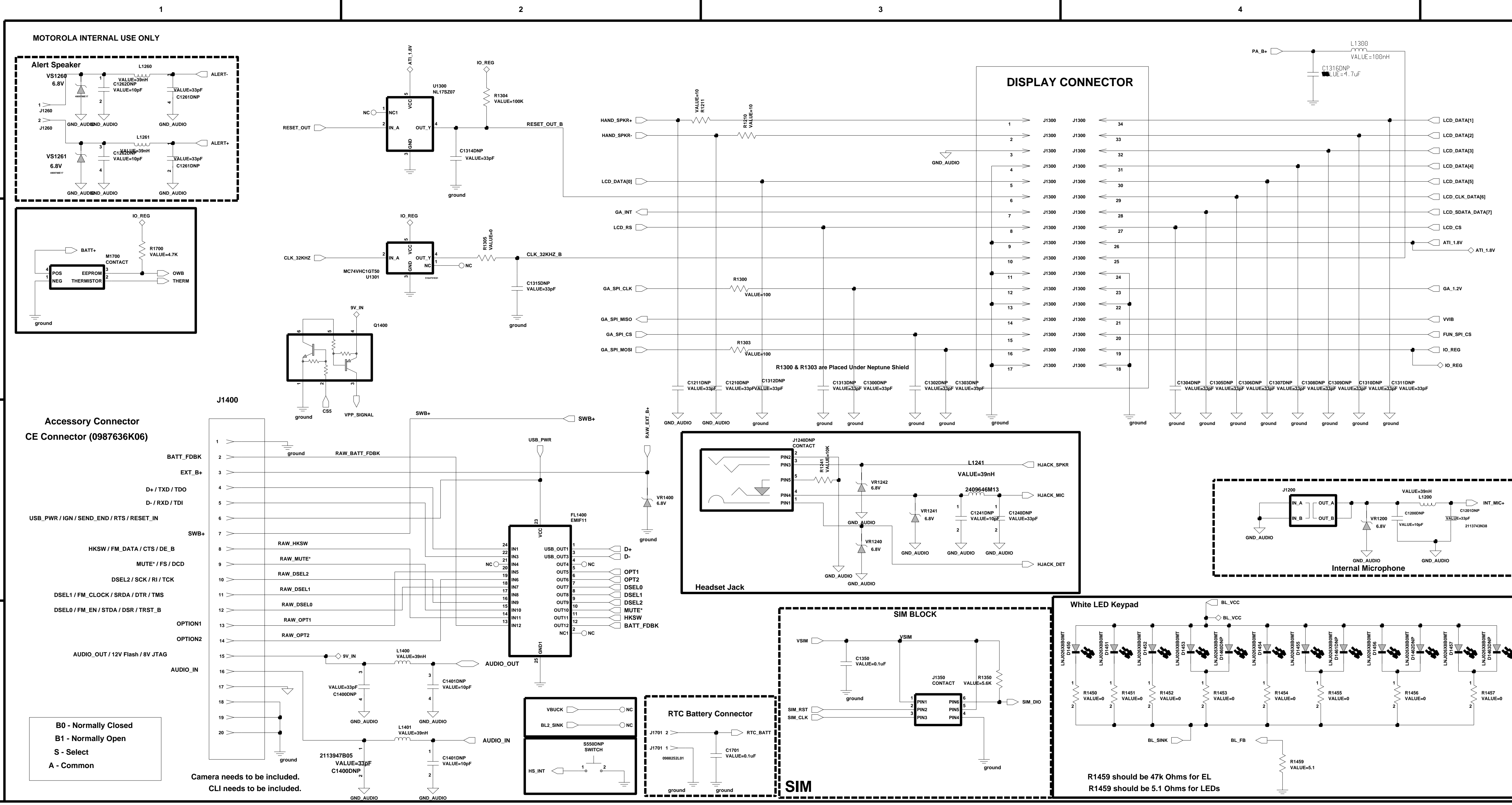

Engineer:	MOTOROLA INC.		
Drawn by:	TITLE: BCC Size:		
R&D CHK:	MFG CTRL CHK:		
DOC CTRL CHK:	REV:	Drawing Number:	Page: Of:
QA CHK:	Date: FRIDAY, DECEMBER, 13 2002 Time:		
Changed by:	Date: FRIDAY, DECEMBER, 13 2002 Time:		
Orrette D. Morris	P2 Changes 12-13-2002		
	12-16-2002		
	01-07-2003		
	01-07-2003		
	01-10-2003		
	01-13-2003		
	01-20-2003		
	02-05-2003		
	02-05-2003		
	02-14-2003		
	02-21-2003		
	02-24-2003		
	02-26-2003		
	02-27-2003		
	03-05-2003		
	03-28-2003		
	04-02-2003		
	04-03-2003		
	04-07-2003		
	04-07-2003		
	04-09-2003		
	04-23-2003		
	06-16-2003		

Change Signal CLI_SPL_CS to FUN_SPL_CS

Update the RESs on the LEDs from 0 ohms to 82 ohms
 BL_SINK RES from 5.6 to 0 ohms
 BL_SINK RES from 0 ohm to E1458DNP

P3.1
 DELETED E1458DNP BL_SINK SHORT BAR
 Deleted C1402, from USB D+ & D-
 Update the RESs on the LEDs from 82 ohms to 470 ohms

P3.2
 Updated S550DNP to PT398TNA33
 Updated J1350 with pin 3970350D02
 DNP LEDs and LED Resistors
 DNP all 33pF filter CAPs
 R1459 value change for EL to 30k
 Added R1600 & R1601 for voltage optio to ATI Chip (2.775V & 1.875V)
 Value change for R1459 to 47k

P3.3
 Added 4.7k pullup to IO_REG
 R1700 on the OWS line
 Added 0.1uF CAP on RTC_BATT to gnd
 Added Q1400 for 9V flashing

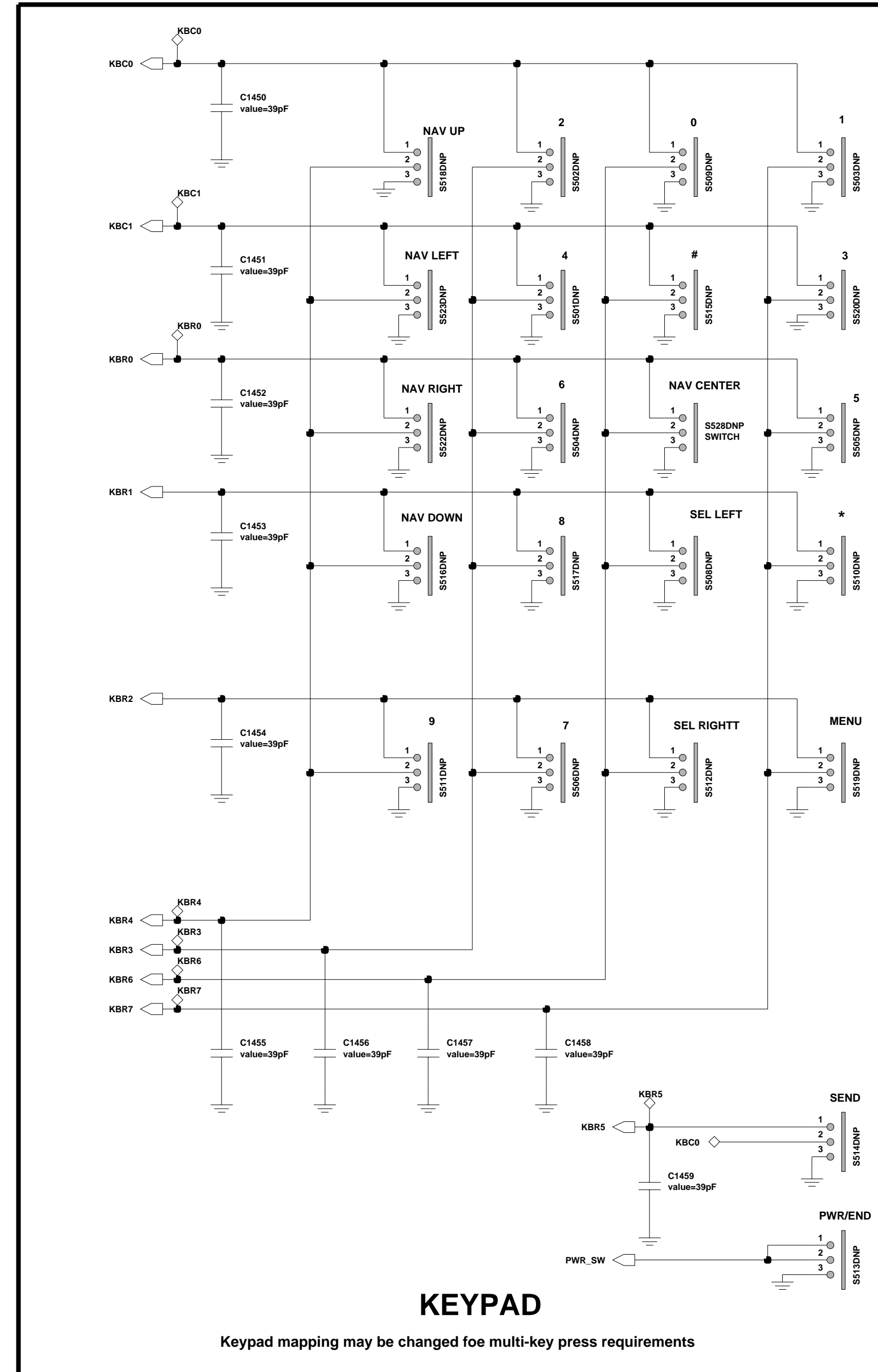
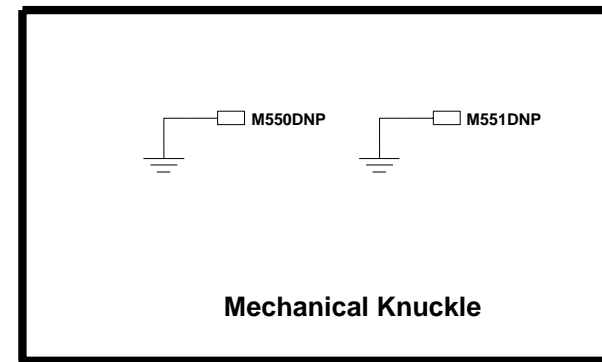
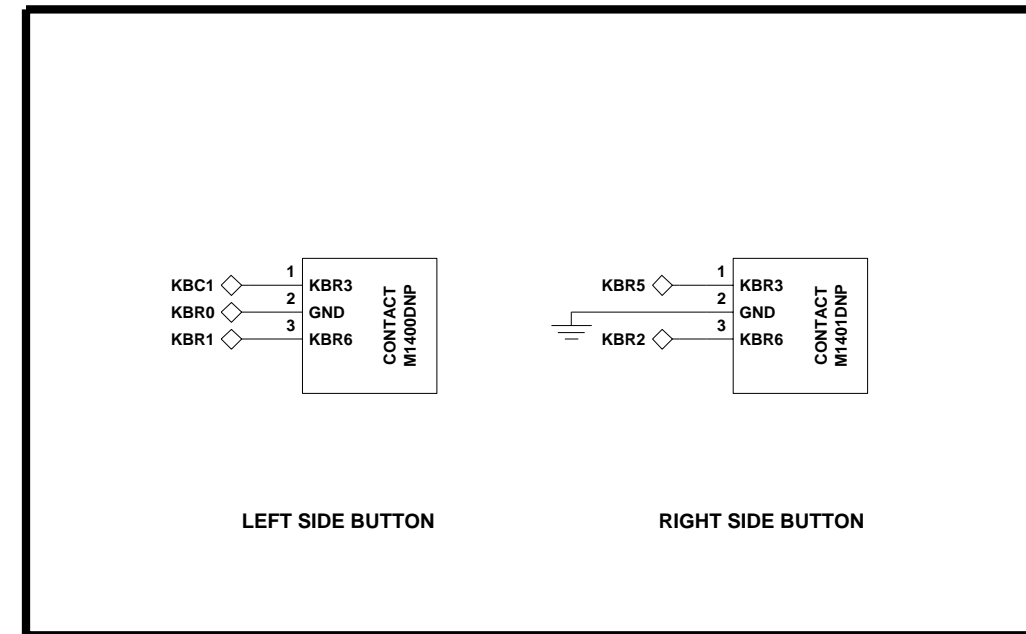
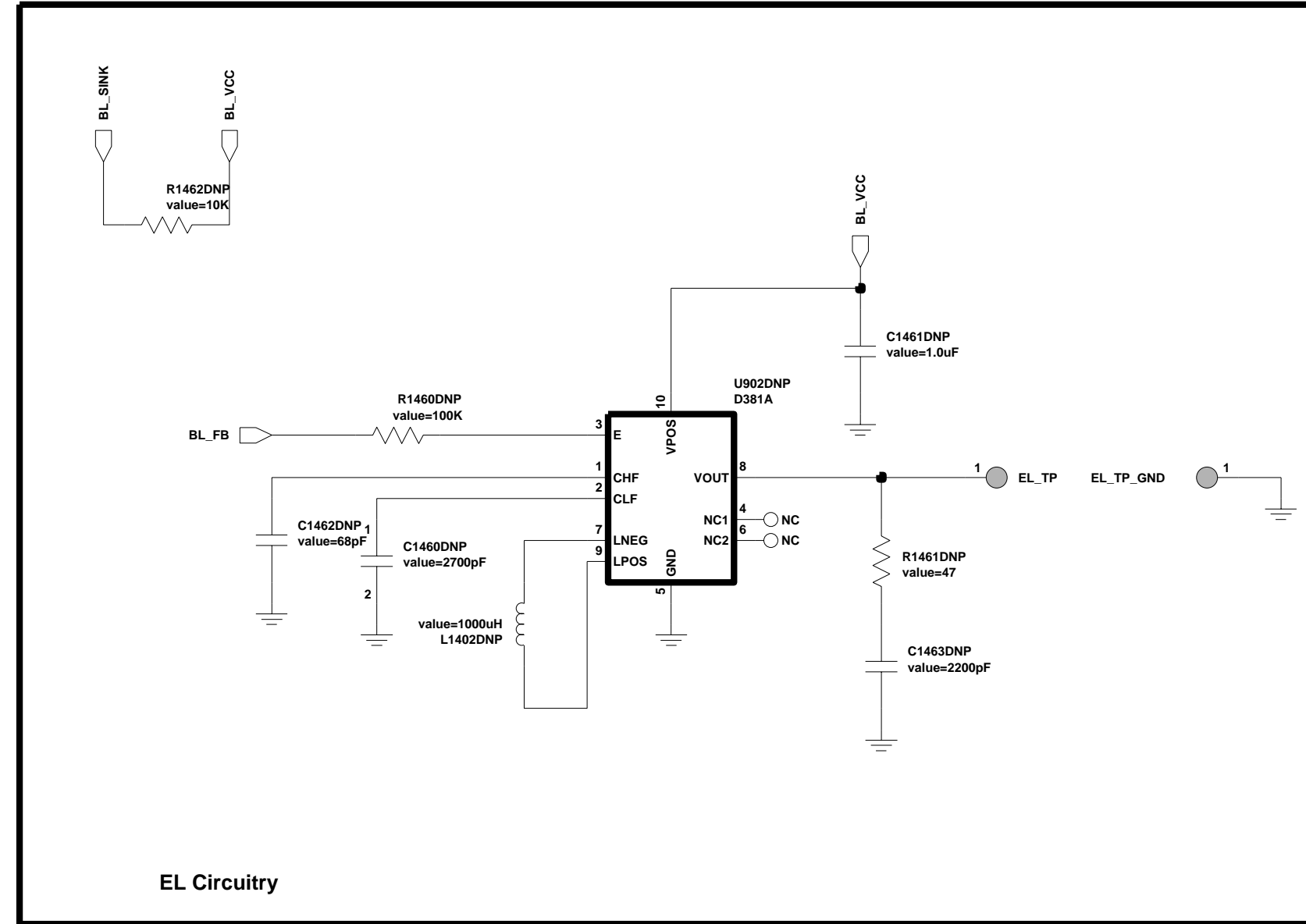

Engineer:		MOTOROLA INC.	
Drawn by:		TITLE: BCC	
R&D CTRL CHK:		Size:	
DOC CTRL CHK:		REV: _____	
MFG CTRL CHK:		Drawing Number: _____	
QA CHK:		Page: _____	
Of: _____		Date: FRIDAY, NOVEMBER, 22 2002	
Changed by: Orrette D. Morris		Time: _____	
01-08-2003	Deleted TPs for Side Buttons Added M1400 & M1401		
02-14-2003	Added M550 & M551		
02-26-2003	P3.1 Deleted M1401 (Side button)		
03-06-2003	Keypad GPIO Changes added KBR5		
03-10-2003	Update Keypad to 5mm pin PT398TNA26		
03-18-2003	Added EL Panel Circuit		
03-18-2003	Added R1465, C1465DNP & TP(EL_TP_B)		
04-02-2003	Deleted R1465, C1465DNP & TP(EL_TP_B)		
04-03-2003	Deleted C1464 Placed R1462 and R1460		
04-07-2003	DNP M1400 & M1401 C1463 value change to 2000pF 0805 package Deleted inverter from EL R1462 value change to 100k R1462 value change to 27k Value Change L1402 to 1000uH Updated Knuckles with new pin PT398TNA38		
04-07-2003	Value change R1462 to 10k C1461 to common pin 2113928A01		
04-23-2003	Change C1463 to pin 2113741529 Change U902 to pin PT51BTNB35 P3.3		
05-21-2003	Changed the following to DNP: C1460 thru C1463, L1402, R1460 thru R1462 & U902		