

E398

Item No.	Motorola Part No.	Description
1	1589893N09	Front Housing Soft Touch Black
1	1589893N11	Front Housing Cosmic Universe Blue
1	1589893N07	Front Housing Star White
2	6189782N01	Lens (for Soft Touch Black)
2	6189782N02	Lens (for Cosmic U Blue & Star White)
3	5089574N01	Speaker
4	4089521N01	Volume BTN Switch
5	1389787N03	Escutcheon Soft Touch Black
5	1389787N04	Escutcheon Star White
5	1389787N05	Escutcheon Cosmic Universe Blue
5	1389787N07	Escutcheon T-Mobile
6	0589579N03	HS Grommet (for Soft Touch Black)
6	0589579N02	HS Grommet (for C. U. Blue & Star White)
7	3889743N03	Keypad English 3 Key
7a	3887683Y01	Keypad English 4 Key
7	3889743N05	Keypad Cyrillic
7	3889743N06	Keypad Arabic
7	3889743N04	Keypad Hebrew
8	0189678N02	Keyboard PCB 3 Key
8	0187816Y01	Keyboard PCB 4 Key

Item No.	Motorola Part No.	Description
9	7289638N01	Display Assy
10	1587437Y01	Joystick Cap
11	0589598N01	Mic. Grommet
12	5087974K02	Microphone
13	1589605N02	Chassis Speaker Assy
14	0189619N03	Camera Assy
15	1589794N06	Rear Housing Soft Touch Black
15	1589794N08	Rear Housing Cosmic Universe Blue
15	1589794N07	Rear Housing Star White
16	0589731N02	RF Grommet (for Soft Touch Black)
16	0589731N01	RF Grommet (for C. U. Blue & Star White)
17	0309315B23	Screw long (2)
17	0309315B24	Screw short (4)
18	SNN5699A	Battery
19	SHN8650A	Battery Door Soft Touch Black
19	SHN8649A	Battery Door Cosmic Universe Blue
19	SHN8651A	Battery Door Star White
-	6087603L01	RTC Battery
-	SPN5038A	Charger Euro
-	SPN5039A	Charger UK

 = part of assembly
Please see comments!
 (requires Adobe Acrobat 6.0) 

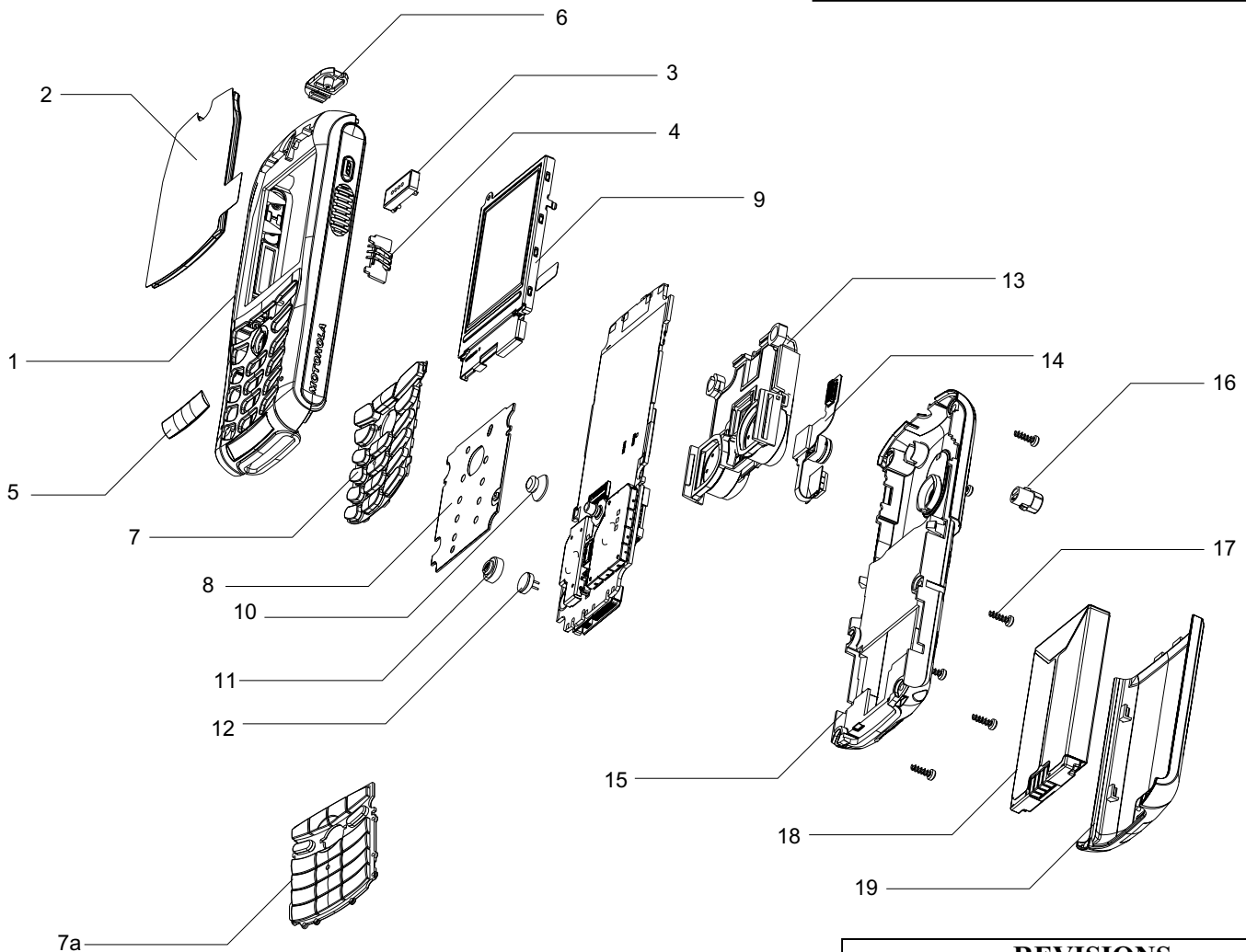

REVISIONS	
	2004.06.16
Level 1-2 Parts List	Version 1.1
E398	
Ralf Lorenzen-Scheil	Page 1 of 1

