

# C380

Item No.	Motorola Part No.	Description
1	CFHN9028A	Front Housing Cosmic Universe Blue
1	CFHN9039A	Front Housing Black Opaque
2	1388161Z01	Escutcheon Cosmic Universe Blue
2	1388161Z04	Escutcheon Black Opaque
3	3888176Z01	Keypad English
3	3888176Z02	Keypad Hebrew
3	3888176Z03	Keypad Cyrillic
3	3888176Z04	Keypad Arabic
4	0309315B21	Screw
5	<b>0788166Z01</b>	<b>Front Endo Assembly</b>
6	5089574N01	Speaker
6a	3288168Z01	Gasket Speaker
7	5089725K04	Microphone
8	0186861P01	Display Assembly
9	4088177Z01	Mylar

Item No.	Motorola Part No.	Description
10	0503646B01	Grommet
11	<b>0188175Z01</b>	<b>Rear Endo Assembly</b>
12	5088564N01	Alert Speaker
12a	3288284Z01	Poron Pad
13	3288171Z01	Acoustic Gasket
14	AANN4285B	Battery
15	CFHN9029A	Rear Housing Cosmic Universe Blue
15	CFHN9036A	Rear Housing Black Opaque
-	6087603L01	RTC Battery
-	SPN4892A	Charger Euro
-	SPN4680B	Charger UK

**[Yellow Highlight]** = part of assembly

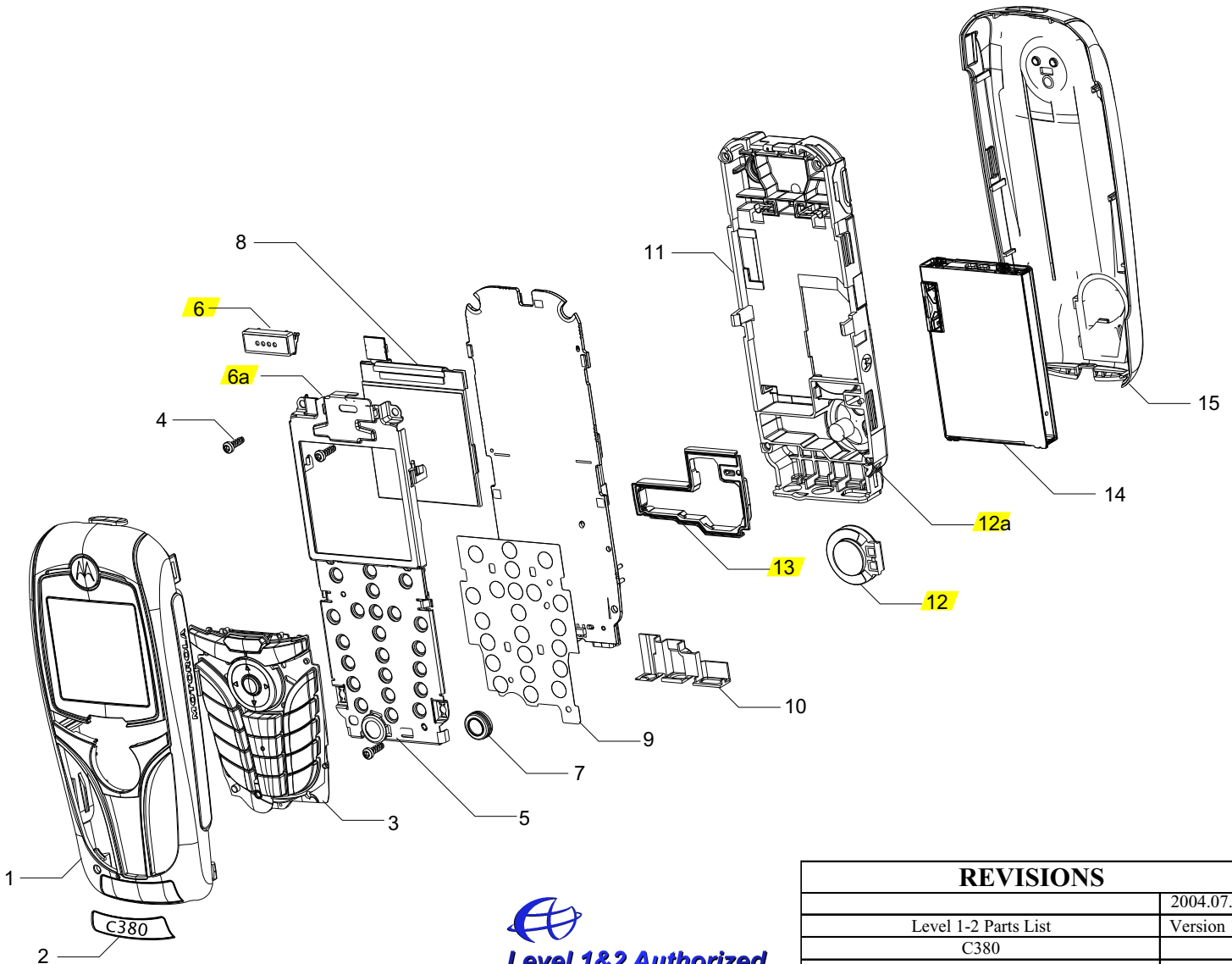

REVISIONS	
	2004.07.27
Level 1-2 Parts List	Version 1.2
C380	
Ralf Lorenzen-Scheil	Page 1 of 1



Level 1&2 Authorized