



www.hellomoto.com

The features detailed here may be a network, subscription and SIM card or service provider dependent feature and not available in all areas. MOTOROLA and the Stylized M Logo are registered in the US Patent & Trademark office. All other products or service names are the property of their respective owners. The Bluetooth trademarks are owned by their proprietor and used by Motorola, Inc. under license.

©Motorola, Inc. 2004
6803602B92

GETTING ACCESSORIZED

Get Connected



Bluetooth® USB PC Adapter



USB Data Cable



TransFlash™ Removable Memory Card with TransFlash™ SD Adapter

Get Audio



One Touch Stereo Headset HS120

Get Hands-Free



Wireless Headset HS820



Wireless Headset HS810



Portable Wireless Speaker HF800

Get Power



Rapid Charger



Battery



Professional Install Hands-Free Car Kit



Desktop Charging Station

Availability of the services and features specified below may depend on your provider. Please contact your service provider for more information.

TIP FOR CONNECTING TO DESKTOP CHARGER

- Plug the travel charger, release tab end, into the back of charging cradle with the release tab up
- Plug the other end into the electrical outlet



PLAYBACK A VIDEO CLIP

- Tap Video Key  in Application Launcher
- A list of video clips will be displayed. Tap on the one you want to play
- To play, pause and stop the video, tap on the buttons displayed at the bottom of the screen

DOWNLOAD A VIDEO

- Use the Web browser to select the link to video
- The Handset establishes a connection and buffering begins
- When buffering is complete, the video starts playing

CONNECT WITH BLUETOOTH

- Open control panel application > Connections > Bluetooth > Devices > Add
- Your communicator searches for Bluetooth devices or tap Show and select from the list, then tap Refresh. If prompted, enter passkey and tap Done
- Choose device from the list and press SELECT.
- Bond with device per device instructions.

PLAY YOUR MP3'S

- Tap Music Key  to show a list of all saved audio tracks
- Tap on the track you want to play
- To rewind, fast forward track press and hold button. To stop or pause track, tap on the buttons displayed at the bottom of the screen

DOWNLOAD AN MP3

- To download a file, follow the instructions on the Web page
- File will open in browser or communicator application
- You can save the file to a folder in the communicator or memory card



A1000

GETTING STARTED & ACCESSORIES

GETTING STARTED

Install the Battery

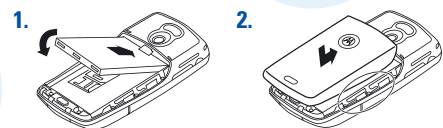

*Insert the battery under the tab and push down

Charge the Battery

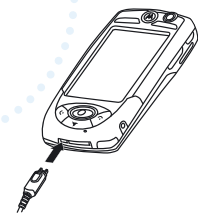

- Plug the travel charger, release tab end, into the bottom end of the handset with the release tab up
- Plug the other end into the electrical outlet

Install/Remove USIM

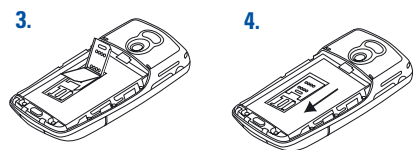
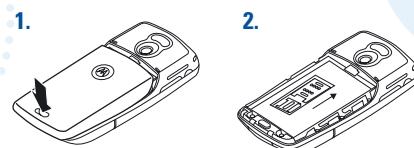

Install/Remove Memory Card

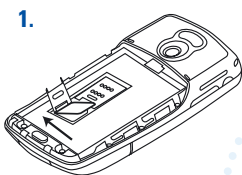

KNOW YOUR MOTOROLA A1000

Turn on/off phone

- Slide Switch Down and Hold

Answering a voice/video call

- Press

Making a voice/video call

- Dial a number and press

End a voice/video call

- Press



TURNING PHONE ON

Slide switch down and hold for 1 second to turn on or off.

METHODS TO CONSERVE BATTERY LIFE

- Switching Bluetooth, AGPS and status LED off
- Tap Bluetooth & AGPS icon on status bar to bring up menu options to turn off and on
- Tap launcher control panel, power, and uncheck the status LED box

CHANGING YOUR RINGTONE

- Open the Phone Icon in Application Launcher
- Tap Settings > Tones
- Select the ring tones you want for line 1 and line 2 (if applicable), video, voicemail and videomail
- To hear the selected ring tone, tap the sound icon
- Select a setting for Keypad tones
- Tap Done

CHANGE WALLPAPER

- Open Application Launcher
- Tap View > Appearance > Background and select wall paper from list
- Select Find image if you want to select a stored image
- Tap Done

TAKE A PICTURE USING CAMERA

- Tap on Camera Icon in Application Launcher
- The camera viewfinder displays the image viewed by the camera lens
- Point camera lens at subject and press center key to take picture
- To save picture, press the center key
- To delete picture, press right arrow on navigation keys or tap the camera icon

SEND A MESSAGE AND A PICTURE USING MMS

- Tap the MMS account in the list of accounts
- Tap Message > New
- Tap Text Only or Text & Media, then tap Done
- In the To field, enter the recipient's phone number or email address. For stored numbers, tap To
- Select file type in the Type field and tap Done
- Tap the stored file to attach and tap Add
- When complete tap Send

INSTALLING APPLICATIONS

Installing from Launcher

- Open Web Browser
- Follow the instructions on the web page to download .SIS file
- Once downloaded, the communicator will automatically start to install

Installing from Desktop Suite

- Desktop Suite must be installed prior to use of external devices, such as Bluetooth
- The A1000 desktop Suite is located on the in-box CD Follow the on-screen prompts for instructions