

# V150 Colour Kramer

Item	Motorola Part No.	Description
1	0103566B01	Front housing flip assembly
2	0185778K28	Flip assembly
3	5504765Z08	Hinge Mechanism
4	1503546B01	Front housing
5	0103563B01	LCD & Flip flex assy
6	1585669K01	Flip ring
7	0185779K19	Flip rear housing
8	3803554B01	Keypad english
8	3803554B02	Keypad cyrillic
8	3803554B03	Keypad hebrew
8	3803554B04	Keypad arabic

Item	Motorola Part No.	Description
9	3203558B01	Acoustic chamber foam
10	6103551B01	Charger light pipe
11	0103555B01	Power flex
12	0103559B02	Rear housing assy
13	AANN4204A	Battery 4mm
13	AANN4258A	Battery 6mm
14	CFYN1000AA	Battery door
15	6185635H04	Light guide
16	0186226P02	Antenna assy
-	5087975K01	Speaker
-	1303638B01	Escutcheon
-	6189095L04	Lens

 = part of assembly

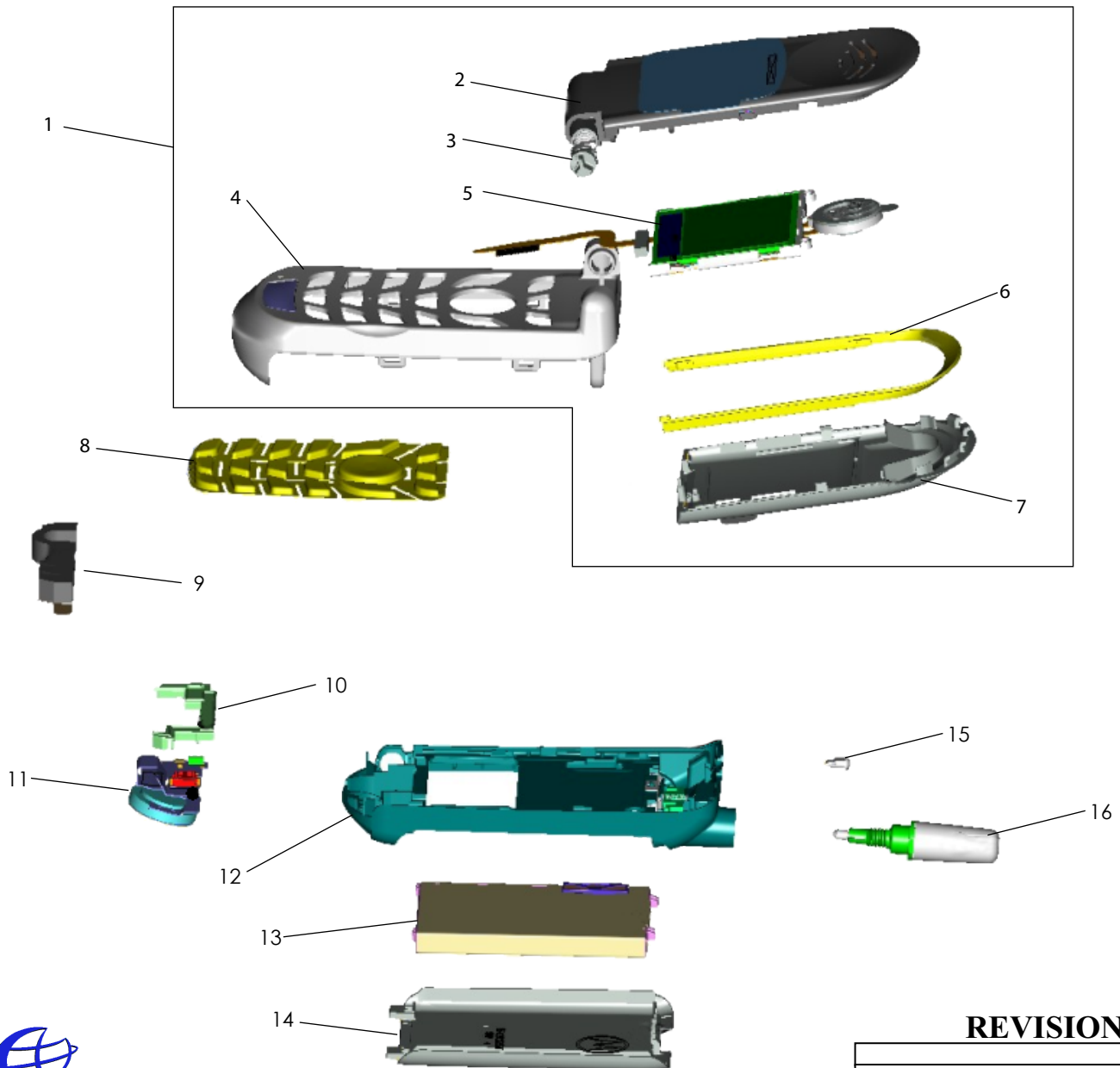

## REVISIONS

	2003.09.19
Level 1-2 Parts List	Version 1.3
V150 Colour Kramer	
Ralf Lorenzen-Scheil	Page 1 of 1



Level 1&2 Authorized